

## Wireless socket for "Pilota Casa" WiFi + radio, IP44 IP20, 230V, 2000W, max. WiFi 30m or radio up to 100m

Item No. 22738

Radio-controlled socket with convenient operation using the free smartphone app (iOS + Android) and contemporary design. And if the app is not enough for you, you can even operate this socket with Amazon Echo or Google Home via voice control!

Wireless socket for the Pilota Casa series in a fascinatingly compact design and with a range of up to 100m. Suitable switches eg #22276 = radio remote control, #22278 1-way radio wall transmitter, #22279 2-way radio wall transmitter. Or simply control it via smartphone app ;-)

### Technical details:

- latest model - 433MHz & WiFi
- Only suitable for indoor and outdoor use
- LED function display for ON/OFF
- Distance to the transmitter max. 30m (free area)
- Frequency: 2.4GHz WiFi & 433MHz
- maximum switching power: 2000W
- maximum radiated transmission power +16dBm
- Connection to 230V / 50Hz
- integrated overload protection
- Dimensions: Ø49x60mm, 98mm deep (with base), inserted 55mm deep.
- Do not plug into each other - operation is only permitted individually.

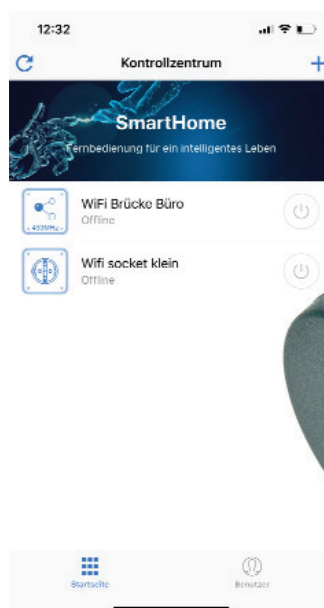

### Safety instructions and important information!

In order to ensure safety at all times and to use the full performance range of the device, please read the safety instructions carefully and at your leisure!

The product must not be modified technically or mechanically, otherwise the operating permit and conformity will expire with immediate effect! The type plate / imprint must not be removed under any circumstances! Check the product for damage before each use. If damage is visible on the product, it must be checked, repaired or replaced by a specialist company and disposed of in accordance with the applicable guidelines (footer page 1). Under no circumstances may a damaged or defective product continue to be put into operation!

Please ensure that all packaging material and accessories, especially small parts such as screws and foils, are protected from children and animals. Danger of suffocation! The manufacturer assumes no liability for property damage or personal injury in the event of non-compliance with the instructions or improper use, misuse or changes made to the product.

This product must never be operated, kept, placed or stored within the reach of children or animals. Please keep these instructions in a safe place. If this product is passed on, the instructions and the packaging must be included. Thanks!

We reserve the right to misprints or changes to the packaging, the product or the instructions.

Electronic products marked with the crossed-out wheeled bin do not belong in household waste! You can hand these products over to municipal collection points free of charge. Inquire here at your municipal administration, the responsible town hall or a local or municipal waste disposal company. Thanks very much. Used batteries should not be put in the household garbage. Consumers are legally obliged to take batteries to a suitable collection point in retail or in the municipality. Old batteries may contain pollutants or heavy metals that can damage the environment and health. The symbols under the label (garbage can) stand for: Pb: battery contains lead, Cd: Battery contains Cadmium Hg: Battery contains mercury. The environment and ChiliTec say thank you.

**safety instructions**

The installation or intervention in the power grid can lead to very serious injuries or even fatal electric shocks • Connection or installation may only be carried out by qualified personnel/electricians in be carried out in a current-free state! The absence of voltage must be checked! • Be sure to observe the UVV (accident prevention regulations) and VDE regulations! Operation only permitted at 230V~ / 50Hz • Installation may only be carried out with approved and tested tools • No installation on or near (50cm distance) combustible / flammable materials (ignition temperature < 200°C). Also pay attention to gas / dust / room air mixture. If necessary, ventilate the room thoroughly beforehand • For all work, switch off the power circuit in which the installation is being carried out at the main fuse completely! Otherwise there is a DANGER TO LIFE!! • When connecting all 230V~ / 50Hz components, the minimum cross-section (1.5mm<sup>2</sup>) of the connecting cable must never be undercut. It is essential that you use a cable that has been expressly approved for this purpose • There are no serviceable parts inside this product • The correct connection must be checked; the voltage may only be switched on again if the installation is faultless • The circuit may only be put into operation when all components have been professionally and securely installed in the wall/mounting/ceiling and checked for full functionality • The permissible connection load must never be exceeded. 5mm<sup>2</sup>) of the connecting cable must never be fallen short of. It is essential that you use a cable that has been expressly approved for this purpose • There are no serviceable parts inside this product • The correct connection must be checked; the voltage may only be switched on again if the installation is faultless • The circuit may only be put into operation when all components have been professionally and securely installed in the wall/mounting/ceiling and checked for full functionality • The permissible connection load must never be exceeded. 5mm<sup>2</sup>) of the connecting cable must never be fallen short of. It is essential that you use a cable that has been expressly approved for this purpose • There are no serviceable parts inside this product • The correct connection must be checked; the voltage may only be switched on again if the installation is faultless • The circuit may only be put into operation when all components have been professionally and securely installed in the wall/mounting/ceiling and checked for full functionality • The permissible connection load must never be exceeded.

- Operation is only permitted individually, installation in a row is prohibited!

**Initial setup of the components**

The two components must be "married" to each other once before they are used for the first time. The connection then remains permanent. To do this, follow the instructions on page 3. "Teaching in the transmitter". The process only takes a few seconds. Put the batteries in the transmitter and switch it on (page 3, fig. 3a). Two or more sockets to be installed must be at least 90 cm apart. The wireless connections are encoded with a 24-bit key and it is therefore not possible to unintentionally teach in third-party devices (e.g. at the neighbors). It is also unlikely that the radio signal will be disrupted, since the radio connection between the components is secure.

**Connection of the receiver 22277 (flush-mounted version) to the mains (optionally available!)**

Observe the above safety instructions - switch off the power at the main fuse! Connect the live incoming wires to the external terminals of the receiver ( see fig. 1). The inner terminals are the switching output. The respective assignment (phase L or neutral conductor) is printed on. The polarity must be observed. Make sure that the cables are tightly screwed and fixed. The cables may only be stripped to such an extent that no bare conductors are visible. When fixing or inserting in the flush-mounted box, make sure that no pressure is exerted on the ON/OFF switch (Fig. 2). To test the switching output, the flush-mounted switch can already be operated via the ON/OFF switch (Fig. 2) after the main power has been switched on again, and the switching activity is indicated by the indicator LED (Fig.

**Connection of socket version 22737/22738 - wireless connection (WiFi see page 4)**

Plug the socket into a protective contact socket. After approx. 3 seconds, the indicator LED (Fig. 1 - green / red) starts to flash, the red flashing stands for the registration mode RF (radio 433MHz). The registration mode red (e.g. for remote control or wall transmitter 433MHz) is automatically reactivated after each reconnection to the power supply). NOTE WiFi (WLAN) registration the green LED flashes slowly (approx. every second) for EZ-WiFi mode or fast (approx. 3-4x per second) for AP-WiFi mode - Hold the on / off switch of the receiver for approx. 5 seconds and to switch between the flashing speeds.

Fig. 1

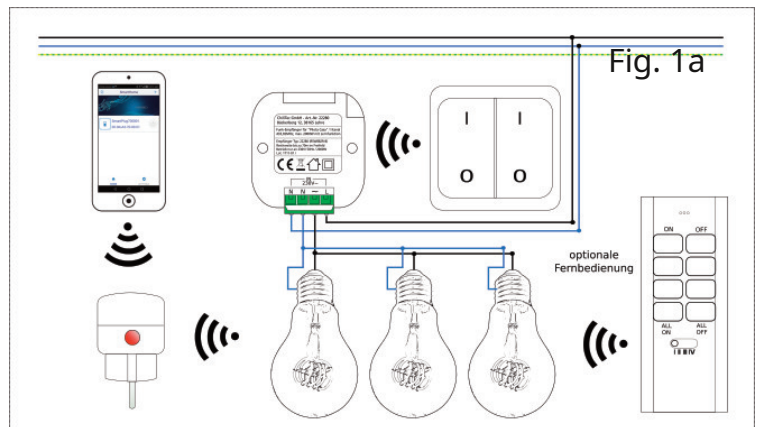
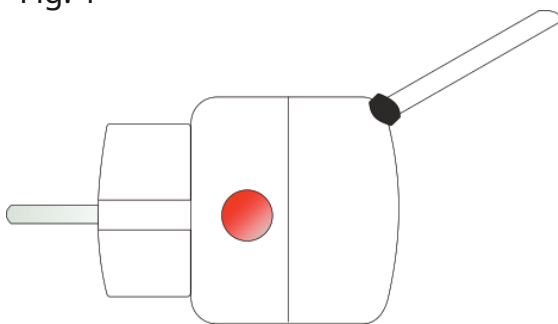

Two or more sockets to be installed must have a minimum distance of 90 cm from each other. The wireless connections are encoded with a 24-bit key and it is therefore not possible to unintentionally teach in third-party devices (e.g. at the neighbors). It is also unlikely that the radio signal will be disrupted, since the radio connection between the components is secure.

**Teaching in the transmitter remote control, magnetic switch, motion detector, etc.**

Item No. 22738

- First insert the battery into the respective transmitter with the correct polarity.  
(See, for example, illustrations) The battery compartments are located under the shift paddles (simply pull off to the front) or, in the case of a remote control/magnet, on the back.
- Switch on the power for the receiver (or plug in the socket). After approx. 3 seconds the indicator LED (Fig. 2) starts to flash (or in the factory setting automatically when plugged in for the first time!).  
The blinking signals the registration mode. If the LED is NOT flashing (approx. every second) - Press and hold the ON/OFF button of the receiver (Fig. 2) for approx. 3 seconds.
- The indicator LED flashes for approx. 12 seconds. During this time, new switching components (up to 10 different transmitters for one receiver) can be learned.
- During the 12 seconds in which the indicator LED is flashing, press the teach button (Fig. 3 ON - I buttons) on the desired transmitter and keep it pressed until the indicator LED (Fig. 2) goes out. The two components are now "married" and you can now use the transmitter (Fig. 3) to operate the receiver (Fig. 2), or switch it on or off.
- The programming is retained permanently, even in the event of a power failure. The same principle also applies to all other transmitter components such as the remote control. In principle, learning a wall switch works the same way, but to log out, press the OFF button "0" on the respective transmitter or "OFF" on the remote control.
- The learning (Fig. 3 OFF /0 buttons) of BWMs or magnetic switches works in the learning mode of the receiver (receiver button > 3 seconds) by also holding down the for 3 seconds  
Programming button of the transmitter .
- Please note that reinforced concrete, stone, glazing and other radio components reduce the range of the radio connection.

Fig. 2

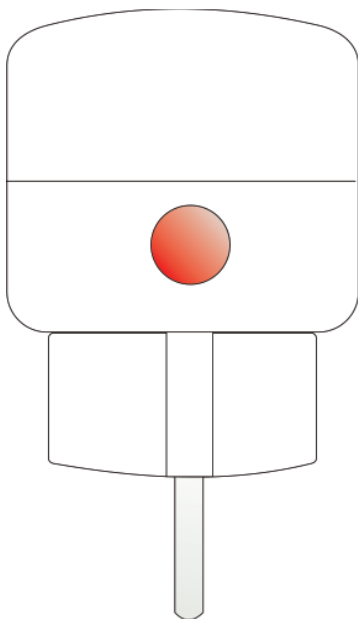

Fig. 3

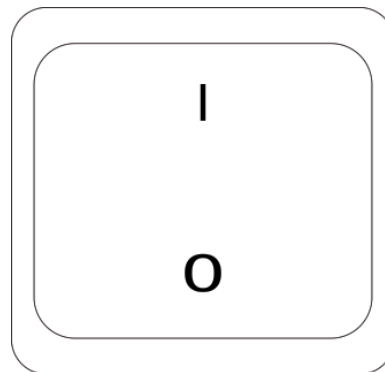
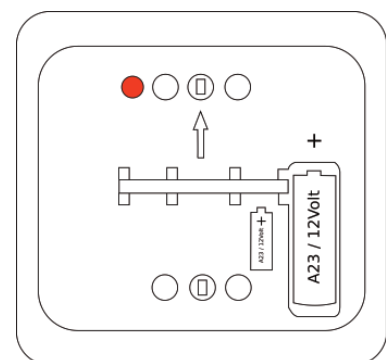

Fig. 3a



**- Notes on cleaning, care and environmental protection -**

Clean this product with a dry, lint-free cotton cloth. For heavier soiling, possibly with a slightly damp, slightly damp cloth. Make sure that the product is switched off and disconnected from the mains. Never use chemical cleaning agents. Never use liquids that could damage the surface of the product (e.g. scouring cream). The product contains no serviceable parts. The product is marked with a crossed-out garbage can. Please note the disposal information in the footer on the first page of these instructions.

Item No. 22738

Instructions for use via app via wifi connection

The technically mature app offers, among other things, many switching options. Each component can be provided with a freely selectable name. The components can also be grouped so that you can switch multiple components with "one click". Another highlight is operation by voice command via various third-party language assistants such as Amazon's Alexa (Echo or Echo Dot) or Google's Home (Google Home or Home Mini). All components are designed for operation at 230V/50Hz. A smartphone/tablet with the latest operating system (iOS > 10.3x or Android > 8.0) is required to operate this system. Likewise, a perfectly functioning WLAN network with 2.4 GHz. Due to the wide range of functions of the app, we can unfortunately only refer to the basic function or registration of a component. The smartphone must be registered in the 2.4 GHz WLAN for registration.

Download the RS-SmartHome app from the Playstore (Android) or AppStore (IOS).

The green coupling LED for the WLAN coupling goes out after 5 minutes flashing and the pairing process is then completed. A new pairing process is started when the socket is plugged in again.

1. Caution: The component to be taught must be within a range of 10m from the router. Otherwise there may be problems.

2.

3.

4.

5.

6.

7.

8th.

9.

App: 1. Install the app and make sure the components, router and smartphone are ready. 2. Register a new account. 3. Fill in the data > confirm. 4. Add to your WiFi network. Press the "+" and "next".

5. Press the button on your component until the LED flashes. 6. Fill in the access password (SSID is displayed) for your WLAN and press "next". 7. The WLAN connection is established. 8. Enter your own name for the component and press "OK". 9. The component has been successfully connected and can now be operated.

## Wireless socket for "Pilota Casa" WiFi

Item No. 22738

### Technical details:

- Simple learning function (learns the appropriate code from the transmitter and remembers it)
- LED function display for ON/OFF and status of the learning function
- Distance to the transmitter max. 30m (free area)
- Frequency: 433.92MHz / 2.4GHz
- maximum switching power: 2000W
- maximum radiated transmission power +16dBm
- Connection to 230V / 50Hz
- integrated overload protection
- Dimensions: Ø49x80mm (with base), inserted 42mm deep.

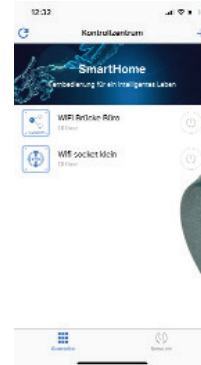

The product must not be changed technically or mechanically, otherwise the operating license and the conformity will expire immediately!! The type plate or imprint must not be removed under any circumstances! Before each use, check the product for possible damage. We assume no liability for property damage or personal injury for non-compliance with the instructions or improper use, misappropriation or improper use.

### Declaration of Conformity (EG Declaration of Conformity)

Company / brand / EAN / item no. / Item designation / Manufacturer designation (type)

ChiliTec GmbH, Bäckerberg 12, 38165 Lehre-Essenrode, Germany

EAN: 4250416327505 / item no. 22738 / Designation: WiFi socket IP44 for "Pilota Casa" / RSN9071/2R-F Product designation / time or date of first placing on the market: WiFi socket IP44 for "Pilota Casa" / October 2020

### The product set has been tested according to the following standards/guidelines:

DIN VDE 0620-2-1:2016+A1:2017  
 EN 61058-1-1:2016  
 EN 61058-1-:2018  
 EN62311:2008  
 EN 301 489-1 V2.2.3(2019-11) EN 301  
 489-3 V2.1.1(2019-03) ETSI EN301  
 489-17 v 3.1.1 (2017-02) ETSI EN300  
 328 v 2.1.1 (2016- 11) EN 300 220-1  
 V3.1.1 (2017-02)  
 EN 300 220-2 V3.2.1 (2018-06)

IEC 62321-1:2013  
 IEC 62321-2:2013+A1:2017  
 IEC 62321-4:2013+A1:2017  
 IEC 62321-5:2013  
 IEC 62321-7-1:2015  
 IEC 62321-7-2:2017  
 IEC 62321-6:2015

We hereby declare, based on information from the manufacturing factory, that the listed product meets the conditions, necessary technical requirements and requirements with regard to electrical safety. Furthermore, the guidelines of the Council for the harmonization of the legal regulations of the EU member states regarding electromagnetic compatibility (2014/30/EU) and Low Voltage Directive (2014/35/EU) as well as ROHS (2011/65/EG), Radio Equipment Directive (2014/53/EU) and Ecodesign (1275/2008/EC-801/2013 EU) fulfilled. The right to bear the CE mark is fulfilled by conformity to the EMC/LVD/ROHS/RED/ErP directives.

Teaching, November 15, 2021

place and date

T Meyer

name and signature



Electronic devices that are marked with the crossed-out wheeled bin do not belong in the household waste! You can hand in these devices free of charge to municipal collection points. Inquire here at your municipal administration, the responsible town hall or a local or municipal waste disposal company. Thanks very much.